

**↑↑↑  
PUSH  
FIT**



# **RF INTERLINK BASE**

**MODEL: DS700RF**

**Save time & money on your installation projects**

---

**CONTACT**

+44 (0) 2476 323232

---

**VISIT US ONLINE**

[www.brk.co.uk](http://www.brk.co.uk)

**BRK<sup>®</sup>**  
**THE PROFESSIONAL STANDARD**

A Sprue Safety Products Brand



# INTRODUCING THE RF INTERLINK BASE...

The “RF base” is a system that provides a wireless interlink between mains powered smoke and heat alarms; it is quick to install and quick to link, ensuring greater output and savings.

The base unit has been designed to transmit a Radio Frequency (RF) signal, when the alarm attached to it senses smoke or fire. When another RF base receives this signal the attached smoke or heat alarm will also sound, eliminating the need for connection wires between each alarm. This is also a particularly useful system to use when refurbishing or extending an existing property.

**“Eliminates the need to run long interconnecting wires around a building”**

The RF base features a unique identification (ID) coding system that prevents individual systems in a group of properties from interacting with each other causing nuisance alarms.

## SAVE TIME AND MONEY ON YOUR PROJECTS...

No extra wires, means no mess and no fuss. Time on site is kept to a minimum with very little disruption to a property. There is no need to lift floor boards and carpets or channel out walls even re-decorating after an installation can now be avoided. Home owners and tenants will benefit from minimum disruption during the whole installation process.

No extra wires.....

No mess.....

No fuss.....

**“RF technology is an installer’s dream...”**

**NO** cables and electrical trunking to worry about

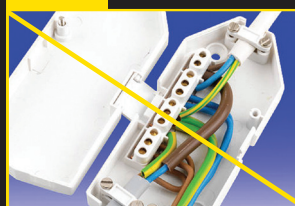

**NO** removing carpets & floorboards

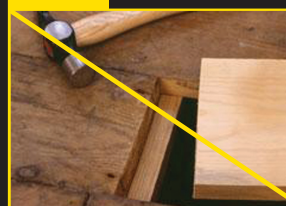

## PROTECTION WHEN YOU NEED IT...

The RF base incorporates the very latest lithium battery technology. Built in tamper proof cells provide a minimum of 10 year life ensuring continuous protection even in the event of a power cut!

**“Minimum disruption during the installation process”**

Each base unit is equipped with a radio receiver and transmitter which can be used with up to 50 smoke and heat alarms.

Ionisation, optical smoke and heat alarms can all be used on the same system for maximum protection.

# RF TECHNOLOGY AROUND THE HOME...

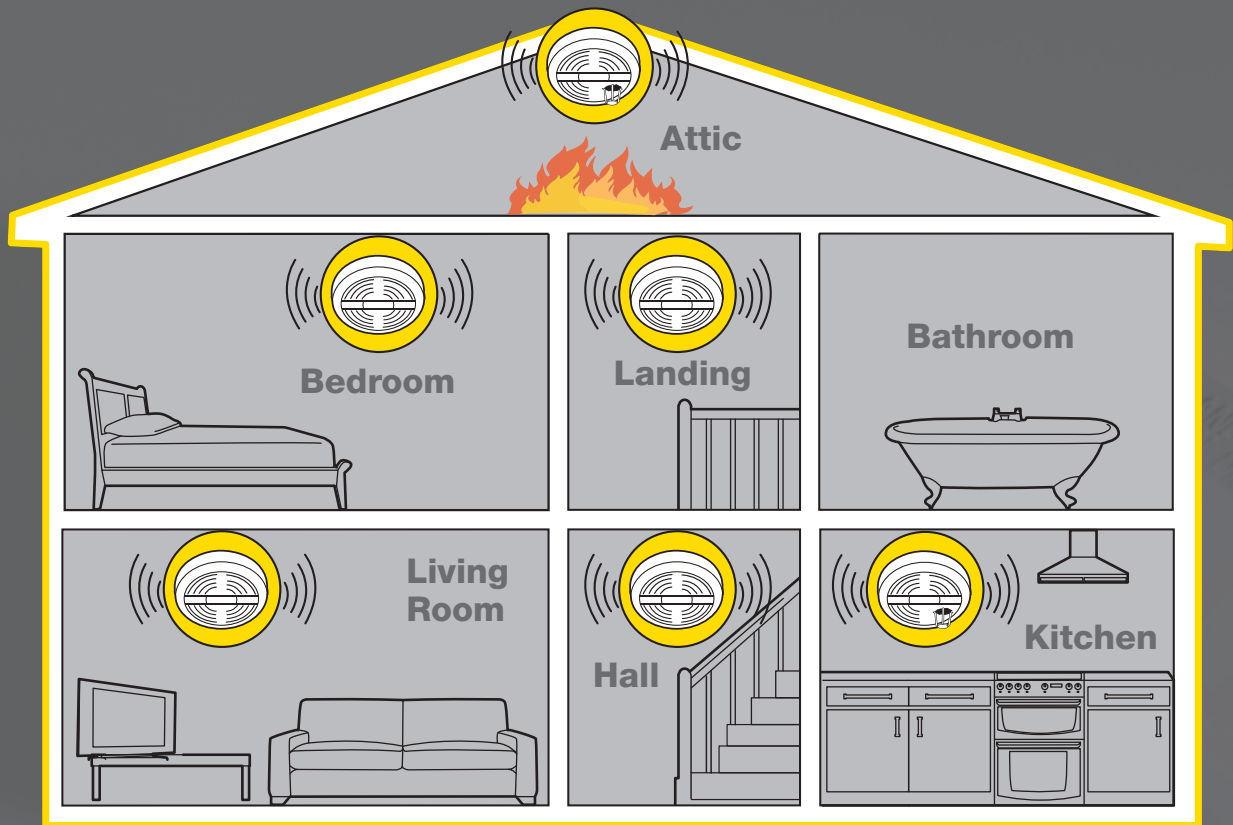

## QUICK SET-UP INSTALLATION GUIDE...



### About Push-Fit

The Push-Fit system has been specifically designed to ensure quick and easy installation of base unit to the mains feed supply at initial installation stage (1st fix) and for quick and easy connection of alarm to base unit (2nd fix).

### Quick set-up guide

A really simple system to install in 3 easy steps

1. Screw mounting base firmly to ceiling using the fixings provided
2. Connect the mains wires to the terminal block
3. Push-fit the alarm into place. No need for additional connector leads



# RF INTERLINK BASE

## MODEL: DS700RF

The RF base provides a wireless link between smoke & heat alarms. Eliminates the need for connection wires between each alarm. Can be used with any BRK mains operated smoke and heat alarms in the 650, 670 and 680 series.

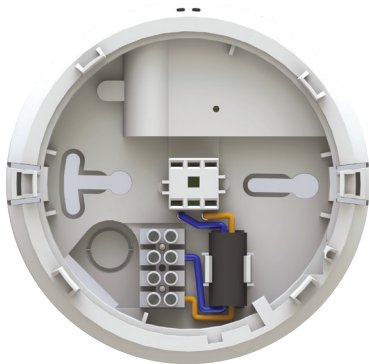

### Product features:

- 10yr lithium battery
- “Push-fit” docking base system
- Automatic ID coding
- Multiple repeater RF signalling
- RF transmitter and receiver in each base unit
- Interlink up to 50 smoke & heat alarms
- Audible & visual LED fault warnings
- 5 year guarantee

<b>Model Number</b>	DS700RF
<b>Description</b>	RF base system
<b>Technology</b>	Radio frequency: 868MHz
<b>Sensitivity</b>	N/A
<b>Alarm sound level</b>	Refer to smoke or heat alarm manual
<b>Battery type</b>	10yr lithium battery
<b>Operation AC/DC</b>	DC
<b>Installation positions</b>	Ceiling (range 30m open area) 150m min
<b>Operating temperature</b>	5°C (40°F) to 38°C (100°F)
<b>Operating humidity</b>	10% to 85% relative
<b>Storage temperature</b>	5°C (40°F) to 38°C (100°F)
<b>Storage humidity</b>	10% to 85% relative
<b>Guarantee</b>	5 years

<b>Unit dimensions</b>	140mm (Diameter) x 30mm (Height)
<b>Unit weight</b>	128g
<b>Pack dimensions</b>	142mm (H) x 142mm (W) x 35mm (D)
<b>Pack weight</b>	170g
<b>Master pack quantity</b>	10
<b>Master pack dimensions</b>	155mm (H) x 190mm (W) x 280mm (D)
<b>Master pack weight</b>	2076g
<b>Pack barcode</b>	5022391064275
<b>Outer barcode</b>	15022391064272

<b>Approvals</b>	Independently tested and compliant with EMC, electrical Safety and Radio Regulations to include requirements of the R&TTE Directive.  EN300220 v2.3.2 (2010.02) EN301489-1 EN301489-3 EN50130-4 EN60065
------------------	---

Please note that specifications may be subject to change at any time.

### CONTACT

TEL : +44 (0) 2476 323232  
 FAX : +44 (0) 2476 693610  
 EMAIL : sales@brk.co.uk

### VISIT US ONLINE

www.brk.co.uk

### SPRUE SAFETY PRODUCTS LTD

Unit 6, Carter Court, Davy Way  
 Waterwells Business Park, Quedgeley  
 Gloucester, GL2 2DE  
 United Kingdom

